



भारतीय राष्ट्रीय राजमार्ग प्राधिकरण

(सड़क परिवहन एवं राजमार्ग मंत्रालय, भारत सरकार)

National Highways Authority of India

(Ministry of Road Transport & Highways, Govt. of India)

क्षेत्रीय कार्यालय (उत्तराखण्ड) - मकान नं.-58/37, बलबीर रोड, देहरादून- 248001

Regional Office (Uttarakhand) - House No.-58/37, Balbir Road, Dehradun- 248 001

Phone : 0135-2669752 & 62 E-mail : routtarakhand@nhai.org Website : www.nhai.gov.in



50063 / NHAI/RO-UKD/2014/ 19017

June 12, 2023

SSub:- Proposal for permission to M/s Uttarakhand Peyjal Nigam for laying of following Water Pipelines (Total length - 2458 m) in Roorkee-Haridwar stretch of NH-58 in District Haridwar in the state of Uttarakhand.

- Laying of 150 mm dia. from Ch.189+962 to Ch. 190+650 in a length of 688 m.
- Laying of 250 mm dia. from Ch. 190+650 to Ch.190+750 in a length of 100 m.
- Laying of 350 mm dia. from Ch. 192+350 to Ch. 192+600 in a length of 250 m.
- Laying of 250 mm dia. from Ch. 192+600 to Ch.193+100 in a length of 500 m.
- Laying of 200 mm dia. from Ch. 193+100 to Ch. 193+185 in a length of 85 m.
- Laying of 200 mm dia. from Ch.192+350 to Ch. 193+185 in a length of 835 m.

The subject proposal is regarding seeking permission by M/s Uttarakhand Peyjal Nigam for laying of water pipelines (total length-2458 m) in Roorkee-Haridwar stretch of NH-58 in District Haridwar in the state of Uttarakhand as submitted/recommended to this office by PD, PIU-Roorkee vide their letter no. NHAI/PIU- RRK/NH-58/11016/NOC/2021/7618 dated 18.04.2023 (Copy enclosed with checklist & drawings).

2. The proposal locations for laying of water pipelines are tabulated hereunder:

Sl. No.	Chainage in Km.			NH	Length (in m)	Methodology of laying Pipeline in this stretch	Remarks
	From	To	Side				
1.	189+962	190+650	RHS	58	688	Through Open Trench Method	Along the NH
2.	190+650	190+750	RHS	58	100		Along the NH
3.	192+350	192+600	RHS	58	250		Along the NH
4.	192+600	193+100	RHS	58	500		Along the NH
5.	193+100	193+185	RHS	58	85		Along the NH
6.	192+350	193+185	RHS	58	835		Along the NH

3. As per MORTH Guidelines no. RW/NH-33044/29/2015S&R(R) dated 22.11.2016, the Highway Administrator will make available the subject proposal for 30 days in the public domain for seeking public comments/objections (on the ground of public inconvenience, safety and general public interest).

In view of above, comments/objections of the public on the above proposal is invited to the below mentioned address, which should reach to this office within 30 days from the date of uploading beyond which no comments shall be entertained.

The Regional Officer,
Regional Office-Uttarakhand
National Highways Authority of India
(Ministry of Road, Transport & Highways)
House No.-58/37, Balbir Road, Dehradun-248001

Yours faithfully,

(Vishal Gupta)
RO-Uttarakhand

Encl: As above.

Copy to:

- 1) Web Admin-NHAI HQ, New Delhi:- with request for uploading on the NHAI website.
- 2) Senior Technical Director, NIC, Transport Bhawan, New Delhi:- With request for uploading on the Ministry's Website.
- 3) PD, PIU-Roorkee- for information & suitable necessary action.

Name of Work : PROPOSAL FOR RoW PERMISSION FOR LAYING OF WATER SUPPLY PIPELINE FROM KM. CH. 189+962 TO CH. 190+750 & 192+350 TO 193+185 (BAHADRABAD) ALONG THE NH-58 (NEW NH-334) DISTT.- HARIDWAR IN THE STATE OF UTTARAKHAND.

Name of the company applied for permission World Bank Project Unit, Uttarakhand Peyjal Nigam, B4/1, Devipura, Haridwar

Sl. No.	Village Name	Length (Mtr)	Width (Mtr)	Area (Sq Mtr)	Haridwar Circle rates per Sq. Mtr	Amount (INR)
1	BAHADRABAD BYPASS (CH. 189+962 TO CH. 190+650)	688	0.15	103.20	₹ 35,000.00	₹ 3,612,000.00
2	BAHADRABAD BYPASS (CH. 190+650 TO CH. 190+750)	100	0.25	25.00	₹ 35,000.00	₹ 875,000.00
3	RANIPUR JHAAL TO BAHADRABAD BYPASS JUNCTION (CH. 192+350 TO CH. 192+600)	250	0.35	87.50	₹ 35,000.00	₹ 3,062,500.00
4	RANIPUR JHAAL TO BAHADRABAD BYPASS JUNCTION (CH. 192+600 TO CH. 193+100)	500	0.25	125.00	₹ 35,000.00	₹ 4,375,000.00
5	RANIPUR JHAAL TO BAHADRABAD BYPASS JUNCTION (CH. 193+100 TO CH. 193+185)	85	0.20	17.00	₹ 35,000.00	₹ 595,000.00
6	RANIPUR JHAAL TO BAHADRABAD BYPASS JUNCTION (CH. 192+350 TO CH. 193+185)	835	0.20	167.00	₹ 35,000.00	₹ 5,845,000.00
					Total (A)	₹ 18,364,500.00
License fee (Rs/sqm/per month) = Total(A) / (10*12)						₹ 153,037.50
License fee for 05 Years = (License fee (Rs/sqm/per month))*5*12						₹ 9,182,250.00
For Public Utility 33% of Industrial utilities as per circular No. RW/NH-33044/29/2015/S&R Dated 22/11/2016						₹ 3,030,142.50

Executive Engineer
World Bank Project Unit
Uttarakhand Peyjal Nigam
Haridwar

राघव त्रिपाठी / Raghav Tripathi
प्रबंधक (तकनीकी) / Manager (Tech.)
भारतीय राष्ट्रीय राजमार्ग प्राधिकरण
National Highway Authority of India
पीओआर-रूड़की / PIU-Roorkee

Name of Work : PROPOSAL FOR RoW PERMISSION FOR LAYING OF**150mm Ø, 200mm Ø, 250mm Ø & 350mm Ø**

150mm Ø	688m
200mm Ø	920m
250mm Ø	600m
350mm Ø	250m

PERFORMANCE BANK GUARANTEE (LENGTH (RUNNING METERS. X 100))

2208X100 = 2,20,800.00

PERFORMANCE BANK GUARANTEE (LENGTH (RUNNING METERS. X 250))

250X250 = 62,500.00

TOTAL BANK GUARANTEE Rs. 2,83,300.00

राघव त्रिपाठी / Raghav Tripathi
प्रबंधक (तकनीकी) / Manager (Tech.)
भारतीय राष्ट्रीय राजमार्ग प्राधिकरण
National Highway Authority of India
पी०आर०के०-रूड़की / PIU-Roorkee



अधिशारी अभियन्ता
विश्व बैंक परियोजना समर्थक
उत्तराखण्ड परियोजना निगम
हरिद्वार



प्रदीप सिंह गुजराई / Pradeep Singh Gusain
परियोजना निदेशक / Project Director
भारतीय राष्ट्रीय राजमार्ग प्राधिकरण
National Highway Authority of India
पी०आर०के०-रूड़की / PIU-Roorkee



CHECK - LIST

Check list for getting approval for Water Supply Pipeline laid on NH Land

Sr. No.	Item	Information/Remarks Status
1	General information	
1.1	Name and address of the applicant/Agency	World Bank Project Unit - Uttarakhand Peyjal Nigam, B4/1, Devipura, Haridwar
1.2	National Highway Number	NH-58 (334)
1.3	State	Uttarakhand
1.4	Location	Bahadradab, Haridwar
1.5	(Chainage in Km.)	Ch. 189+962 to Ch. 190+750 & Ch. 192+350 to Ch. 193+185
1.6	Length in Meters	1623m
1.7	Width of available ROW	As per Drawing
	(a) Left side from centre line towards increasing chainage/km direction	As per Drawing
	(b) Right side from centre line towards increasing chainage/Km. direction	As per Drawing
1.8	proposal to lay underground water supply Pipeline	
	(a) Left side from centre line towards increasing chainage/km direction	As per Drawing
	(b) Right side from centre line towards increasing chainage/Km. direction	As per Drawing
1.9	Proposal to acquire land	No
	(a) Left side from centre line	NA
	(b) Right side from centre line	NA
1.10	Whether proposal in the same side where land is not to be acquired	Yes
	If not then where to lay the pipeline.	As per Drawing
1.11	Details of already laid services, if any, along the proposed route	NO
1.12	Number of lanes (2/4/6/8 lanes) existing	4 - Lanes
1.13	Proposed Number of lanes (2 lane with paved shoulders 6/8 lanes)	NO
1.14	Service Road existing or no:	Yas
	If yes then which side	
	(a) Left side from centre line	As per Drawing
	(b) Right side from centre line	As per Drawing
1.15	Proposed Service Road	NO
	(a) Left side from centre line	NA
	(b) Right side from centre line	NA
1.16	The permission for laying of water supply pipeline shall be considered for approval/rejection based on the Ministry Circulars Mentioned as above	Yes
	(a) Carrying on sewage/gas pipeline on highway bridges shall not be permitted as fumes/gases pipes can accelerate the process of corrosion or may cause explosions thus being much more injurious than leakage of water.	NA

 राघव त्रिपाठी / Raghav Tripathi
 प्रबंधक (तकनीकी) / Manager (Tech.)
 भारतीय राष्ट्रीय राजमार्ग प्राधिकरण
 National Highway Authority of India
 पी.ओ. बॉक्स - ६०००१ / P.O. Roorkee



 Executive Engineer
 World Bank Project Unit
 Uttarakhand Peyjal Nigam
 Haridwar

	(b) Carrying of water pipelines on bridges shall not be discouraged However, if the water supply authorities seem to have no other viable alternative and approach the highway authority well in time before the design of the bridge is finalized they may be permittee to carry the pipeline on independent superstructure, supported on extended portions of piers and abutments in such a manner that in the final arrangement enough free space around the superstructure of the bridge remains available for inspection and repairs etc.	NA
	(c) Cost of required extension of the substructure as well as that of the supporting superstructure shall be borne by the agency -in-charges of the utilities.	Yes
	(d) Services are not being allowed indiscriminately on the parapet any part of the bridges Safety of the bridges has to be kept in view while permitting various services along bridge. Approvals are to be accorded in this regard with the concurrence of the Ministry's project Chief Engineers only.	Yes
1.17	If crossings of the road involved If Yes, it shall be either encased in pipes or through structure or conduits specially built for that purpose at the expenses of the agency owning the line	Yes
	(a) Existing drainage structures shall not be allowed to carry the lines.	Yes
	(b) Is it on a line normal to NH-58 (New NH-334)	Yes
	(c) Crossings shall not be too near the existing structures on the National highway, the minimum distance being 15 meter. What is the distance from the existing structures	Yes
	(d) The casing pipe (or conduit pipe in the case of electric cable) carrying the utility line shall be of steel, cast iron, or reinforced cement concrete and have adequate strength and be large enough to permit ready withdrawal of the carrier pipe/cable.	Yes
	(e) Ends of the casing/conduit pipe shall be sealed from the outside, so that it does not act as a drainage path	Yes
	(e) The casing/conduit pipe should as minimum extend from drain to drain in cuts and be of slope in the fills	Yes
	(g) The top of the casing/conduit pipe should be at least 2 meters below the surface of the road subject to being at least 0.3 meter below the drain inverts.	Yes
	(h) Crossing shall be by boring method (HDD) especially where the existing road pavement of cement concrete or dense bituminous concrete types	Yes
	(i) The casing/conduit pipe shall be installed with an even bearing throughout its length and in such a manner as to prevent the formation of a waterway along it.	Yes
2	Document/Drawings enclosed with the proposal	Yes
2.1	Cross section showing the size of trench for open trenching method (It is normal size of 1.0 meter deep X 0.6 meter wide)	Yes
	(i) Should not be greater than 60cm wider than the outer diameter of the pipe	Yes
	(ii) Located as close to the extremaedge of the right of way possible but not less than 15metre from, the centre lines of the nearest carriageway.	N.A.

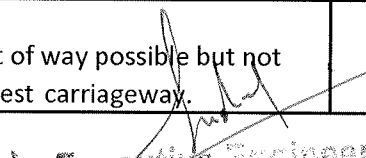
 राघव त्रिपाठी / Raghu Tripathi
 प्रबंधक (तकनीकी) / Manager (Tech.)
 भारतीय राष्ट्रीय राजमार्ग प्राधिकरण
 National Highway Authority of India
 पी.ओ. बॉक्स - २०००१ / P.O. Roorkee

 Executive Engineer
 World Bank Project Unit
 Uttarkhand Nigam
 Haridwar

	(iii) Shall not be permitted to route along the national highways when the road formation is situated in double cutting. Nor shall these be laid over the existing culverts and bridges.	N.A.
	(iv) These should be so laid that their top is at least 0.6 metre below the ground level so as not to obstruct drainage of the road land.	Yes
2.4	Methodology for laying of water supply pipeline	Enclosed
2.4.1	Open trenching method. (May be allowed in utility corridor only where pavement is neither cement concrete nor dense bituminous concrete type.) If yes. Methodology of refilling trench (a) The trench width should be at least 30cm but not more than 60 cm wider than the outer diameter of the pipe (b) For filling of the trench. Bedding shall be to a depth of not less than 30cm. It shall consist of granular material, material, free of lumps, clods and cobbles and graded to yield a firm surface without sudden change in the bearing value. Unsuitable soil and rock edged should be excavated and replaced by selected material (c) The Backfill shall be completed in two stage (i) side fill to the level of the top of the pipe and (ii) overfill to the bottom of the road crust. (d) The side fill shall consist of granular material laid in 15 cm layers each consolidated by mechanical tampering and controlled addition of moisture to 95% of the Proctor's Density. Overfill shall be compacted to the same density as the material that had been removed. Consolidation by saturation or ponding will not be permitted. (e) The road crust shall be built to the same strength as the existing crust on either side of the trench. Care shall be taken to avoid the formation of a dip at the trench. (f) The excavation shall be protected by flagman, signs and barricades and red lights during nights hours (g) If required, as diversion shall be constructed at the expense of agency owning the utility line	Open trenching, Yes
2.4.2	Horizontal Directional Drilling (HDD) Method	Yes
2.4.3	Laying of Water supply pipeline through CD works and method of laying	N.A.
	(a) On approaches, the water mains/cables shall be carried along a line as close to the edge of the right-of-way as possible up-to a distance of 30 meter from the bridge and subject to all other stipulations contained in this Ministry's guidelines issued with letter No - Nil I-HI/P/66/76 dated - 19.11.1976	N.A.
3	Draft License Agreement signed by two witnesses	Enclosed
4	Security Deposit of Rs. 1,00,000/- per crossing of NH for a period of one year initially (extendable if required till satisfactory completion of work) as a security for ensuring/making good the excavated trench for laying the cables/ducts by proper filling and compaction clearing debris/loose earth produced due to execution of trenching at least 50 meter away from the edge of the right of way. No payment shall be payable by the NHAI to the licensee for clearing debris/loose earth	Yes
4.1	Performance BG as per above is to be obtained	To be submitted as per directions of NHAI

 Manish Tripathi / Manager (Tech)
 भारतीय राष्ट्रीय राजमार्ग प्राधिकरण
 National Highway Authority of India
 प्लॉट नं. 10-ए - रोड नं. 1 / पी.यू.-रूरके

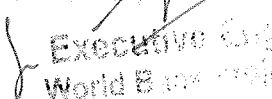
 Executive Engineer
 World Bank Project Unit
 Uttarakhand Rajmarg Nigam
 Haridwar

4.2	Confirmation of BG has been obtained as per MoRT&H guidelines	BG shall be submitted as per MoRTH Guidelines
5	Affidavit/undertaking from the applicant for	
5.1	Not to damage to other utility if damaged then to pay the losses either to NHAI or to the concerned agency	Enclosed
5.2	Confirming all standard condition of MoRT&H guideline	Enclosed
5.3	Shifting of Water/Gas supply pipeline as and when required by MoRT&H at their own cost	Enclosed
5.4	Shifting due to 6/8 lanning/widening of NH	Enclosed
5.5	Indemnity against all damages and claims clause (xxiv)	Enclosed
5.6	Traffic movement during laying of water/gas supply pipeline to be managed by the applicant	Enclosed
5.7	If any claim is raised by the Concessionaire then the same has to be paid by the applicant	Enclosed
5.8	prior approval of the NHAI shall be obtained before undertaking any work of installation shifting or repairs or alterations to the showing Water/Gas supply pipeline located in the National Highway right -of-ways.	Enclosed
5.9	Expenditure if any, incurred by NHAI for repairing any damage caused to the National Highway by the laying maintenance or shifting of the Water/Gas supply pipeline will be borne by the agency owning the line	Enclosed
5.10.	If the NHAI considers it necessary in future to move the utility line for any work of improvement or repairs to the road, it will be carried out as desired by the NHAI at the cost of the agency owning the utility line within a reasonable time (not exceeding 60 days) of the intimation given.	Enclosed
5.11	Certificate from the applicant in the following format	Enclosed
	(i) Laying of Water/Gas supply pipeline will not have any deleterious effects on any of the bridge components and roadway safety for traffic.	
	(ii) for 6/8 lanning "We do undertake that I will relocate service road/approach road utilities at my own cost notwithstanding the permission granted within such time as will be stipulated by NHAI' for future Six/Eight lanning or any other development"	NA
6	Who will sign the agreement on behalf of Water supply pipeline agency	Executive Engineer, World Bank Unit Uttarakhand Peyjal Nigam, Haridwar
7	Power of attorney to sign agreement available or not certificate from the project Director	N.A.
7.1	Certificate for confirming of all standard condition issued vide. Ministry Circular No - NH-41(58)/68 dated 31-1-1969. Ministry Circular No- NH-III/P/66/76 dated 18/19-11- 1976.Ministry Circular No- NH-RW/NH-III/P/66/76 dated - 11/05/1982 Ministry Circular No - RW/NH-11037/1/86 DOI (ii) dated - 28-07-1993. Ministry Circular No- RW/NH-11037/1/86/DOI dated 19-1-1995. Ministry Circular No - RW/NH-34066/2195 S&R dated 25-10-1999 and Ministry Circular No - RW/NH-34066/7/2003 S& R (B) dated - 17-9-2003	
7.2	Certificated from PD in the following format	NA

राष्ट्रीय राजमार्ग प्रबंधक (Technical Manager (Tech.) भारतीय राष्ट्रीय राजमार्ग प्राधिकरण National Highway Authority of India

आध्यात्मिक आनंद
विश्व बैंक परियोजना इकाई
उत्तराखण्ड पेयजल निगम
हरिद्वार

प्रदीप सिंह गुसाई/Pradeep Singh Gusain
परियोजना निदेशक / Project Director
भारतीय राष्ट्रीय राजमार्ग प्राधिकरण
National Highway Authority of India
पीओआर-रूढ़की / P.O.R.-Roorkee

	(i) It is certified that any other location of the water/gas supply pipeline would be extremely difficult and unreasonable costly and the installation of Water/Gas supply pipeline within ROW will not adversely affect the design, stability & traffic safety of the highway nor the likely future improvement such as widening of the carriageway easing of curve etc.	NA
	(ii) for 6/8 - lanning	NA
	(a) Where feasibility is available "I do certify that there will be no hindrance to proposed six-lanning based on the feasibility report considering proposed structures at the said location	NA
	(b) In case feasibility report is not available "I do certify that sufficient ROW is available at site for accommodating proposed six-lanning".	NA
8	If NH section proposed to be taken up by NHAI on BOT basis- a clause is to be inserted in the agreement. The permitted highway on which Licensee has been granted the right of lay pipe/duct has also been granted as a right of way to the concessionaire under the concession agreement for up-gradation of (Dehradun-Haridwar section of NH-72 (New NH 07), from CH. 162.350 Km to 163.360 Km. on Build. Operate) and Transfer Basis and therefore, the licensee shall honor the same.	Yes
9	Who will supervise the work of laying or Water/Gas supply pipeline.	NHAI
10	Who will ensure that the defects in road portion after laying of water/gas supply pipeline are corrected and if not corrected then what action will be taken	NHAI
11	Who will pay the claims for damages done/disruption in working of Concessionaire if asked by the concessionaire	Executive Engineer, World Bank Unit Uttarakhand Peyjal Nigam, Haridwar
12	A certificate from PD that he will enter the proposed permission in the register of records of the permissions in the prescribed proforma (copy enclosed)	Permission will be recorded, in register of records
13	If any previous approval is accordance for laying of underground Water/Gas supply pipeline then Photocopy of register of records of permission accorded as maintained by PD then copy be enclosed	NA

 राघव त्रिपाठी / Raghav Tripathi
 प्रबंधक (तकनीकी) / Manager (Tech.)
 भारतीय राष्ट्रीय राजमार्ग प्राधिकरण
 National Highway Authority of India
 पी०आर०ई०यू०-रूड़की / PIU-Roorkee

 आनंद प्रसादी आभयन्ता
 विश्व बैंक परियोजना इकाई
 उत्तराखण्ड पेयजल निगम
 हरिद्वार

 प्रदीप सिंह गुसाई / Pradeep Singh Gusair
 परियोजना निदेशक / Project Director
 भारतीय राष्ट्रीय राजमार्ग प्राधिकरण
 National Highway Authority of India
 पी०आर०ई०यू०-रूड़की / PIU-Roorkee

Annexure – I

Details of underground Pipelines laid along National Highway

1. (I) Name of company asking for permission : World Bank Project Unit,
Uttarakhand Peyjal Nigam,
Haridwar.
- (II) Contact Person Name & Designation : Executive Engineer
- (III) Full Address : World Bank Project Unit,
Uttarakhand Peyjal Nigam,
B4/1, Devipura, Haridwar
- (V) Details & Purpose for laying the pipeline crossing : Water Supply Pipeline
through NH Land
- (VI) Any other details regarding laying
 - (a) Distance of proposed site from the center of road : As per Drawing
 - (b) Whether it is possible to lay proposed line or not : YES
(reasons)
 - (c) Whether it is possible to cross the proposed line : N.A.
through existing lines or not (reasons)
2. Details regarding road alignment whether U/G cables pipe is : YES
to be laid along the road
 - (I) Name of Road : National Highway No.- 58 (334)
Roorkee – Haridwar Road
 - (II) Width of Road : As per drawing
 - (a) Black Topped carriageway width : As per the attached drawing.
 - (b) Road Boundary (extent of highway land) (All these : As per the drawing.
details are to be shown on the Drawings also)
 - (c) Location of Pipeline crossing : CH. 192+350, CH. 192+592, CH.
193+000 & CH. 193+110.
3. Details to be supplied on layout drawings (5 sets) : Yes
4. Geographies of the Pipeline Route
 - (a) Dimension of the Pipeline trench : 1.0 m depth x 0.6 m width
 - (b) Dimension of Protection Pipe : N.A.
 - (c) Diameter of the Pipeline : 150mm, 200mm, 250mm &
350mm Ø
 - (d) Right of User : 1.00 mt.



Executive Engineer
World Bank Project Unit
Uttarakhand Peyjal Nigam
Haridwar

- (d) Right of User : 1.00 mt.
5. (I) This is to certify that no Government Land shall be occupied by the applicant, except for the purpose of lying of Pipeline. : Agree
- (II) This is to certify that the work shall be in accordance with the Government Rules and regulations in force from time to time and binding to applicant. : Agree
- (III) This is to certify that all required cost & fees as per rules and regulations of the Govt. will be deposited timely. : Agree

राघव त्रिपाठी / Raghav Tripathi
प्रबंधक (तकनीकी) / Manager (Tech.)
भारतीय राष्ट्रीय राजमार्ग प्राधिकरण
National Highway Authority of India
पी०आइ०यू०-रूड़की / PIU-Roorkee

Authorized Signatory

For World Bank Project Unit
Uttarakhand Pwaja Nigam
Haridwar
विश्व बैंक परियोजना इकाई
उत्तराखण्ड पेयजल निगम
हरिद्वार



प्रदीप सिंह गुसाई / Praadeep Singh Gusain
परियोजना निदेशक / Project Director
भारतीय राष्ट्रीय राजमार्ग प्राधिकरण
National Highway Authority of India
पी०आइ०यू०-रूड़की / PIU-Roorkee

WORLD BANK PROJECT UNIT-UTTARAKHAND PEYJAL NIGAM, HARIDWAR

ROUTE NAME - FROM KM. CH. 189+962 TO CH. 190+750 & CH. 192+350 TO CH. 193+185
(BAHADRABAD, HARIDWAR) ALONG THE NH-58 (NEW NH-334) DISTRICT - HARIDWAR
IN THE STATE OF UTTARAKHAND

1

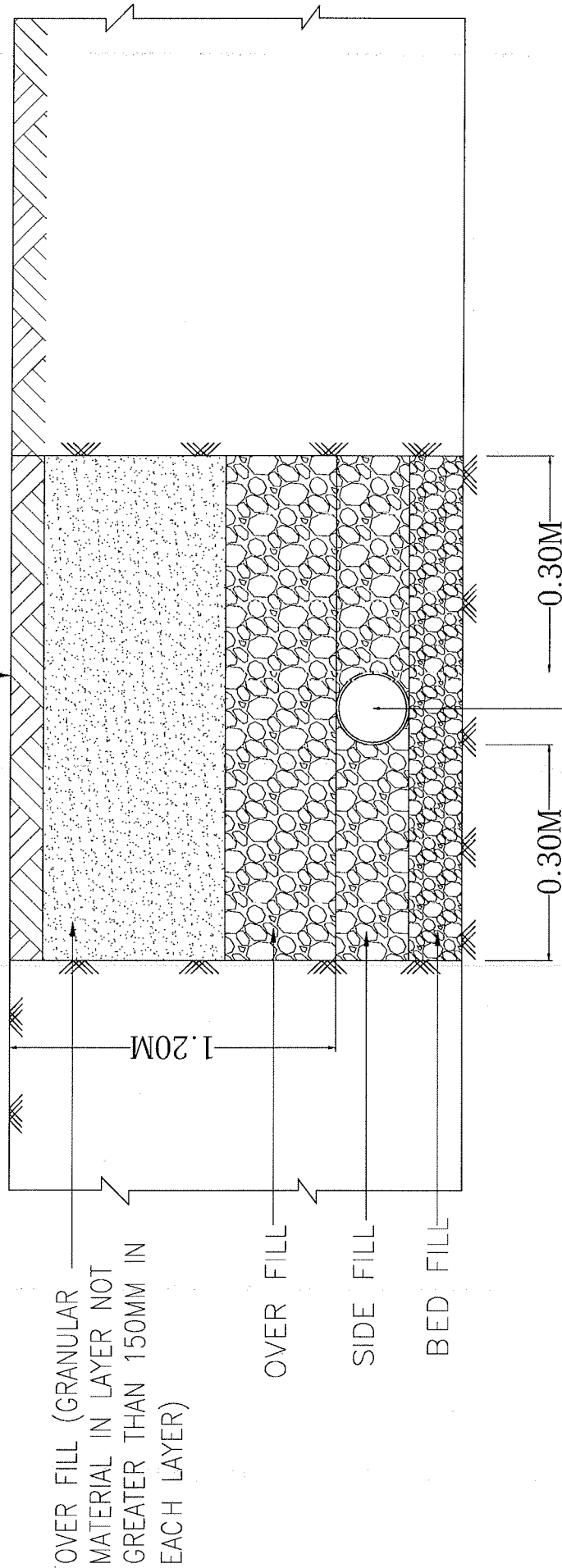
TOP OF ROAD



WATER SUPPLY
PIPELINE

TYPICAL SECTION
(PIPE LINE ALONG ROAD)

राष्ट्रीय निदेशिका / Raghav Tripathi
प्रबंधक (तकनीकी) / Manager (Tech.)
राष्ट्रीय राजमार्ग निदेशिका
National Highway Authority of India
एन.एच.ए.आर. - बंगलौर / NH-Roorkee

राष्ट्रीय निदेशिका / Pradeep Singh Gusain
परियोजना निदेशिका / Project Director
राष्ट्रीय राजमार्ग निदेशिका
National Highway Authority of India
एन.एच.ए.आर. - बंगलौर / NH-Roorkee

ज.ए.

आ. नि. ३०५/१५००
विश्व बैंक परियोजना ३०५
उत्तराखण्ड पेयजल निगम
हरिद्वार

WORLD BANK PROJECT UNIT-UTTARAKHAND PEYJAL NIGAM, HARIDWAR

ROUTE NAME - FROM KM. CH. 189+962 TO CH. 190+750 & CH. 192+350 TO CH. 193+185
(BAHADRABAD, HARIDWAR) ALONG THE NH-58 (NEW NH-334) DISTRICT - HARIDWAR
IN THE STATE OF UTTARAKHAND

2

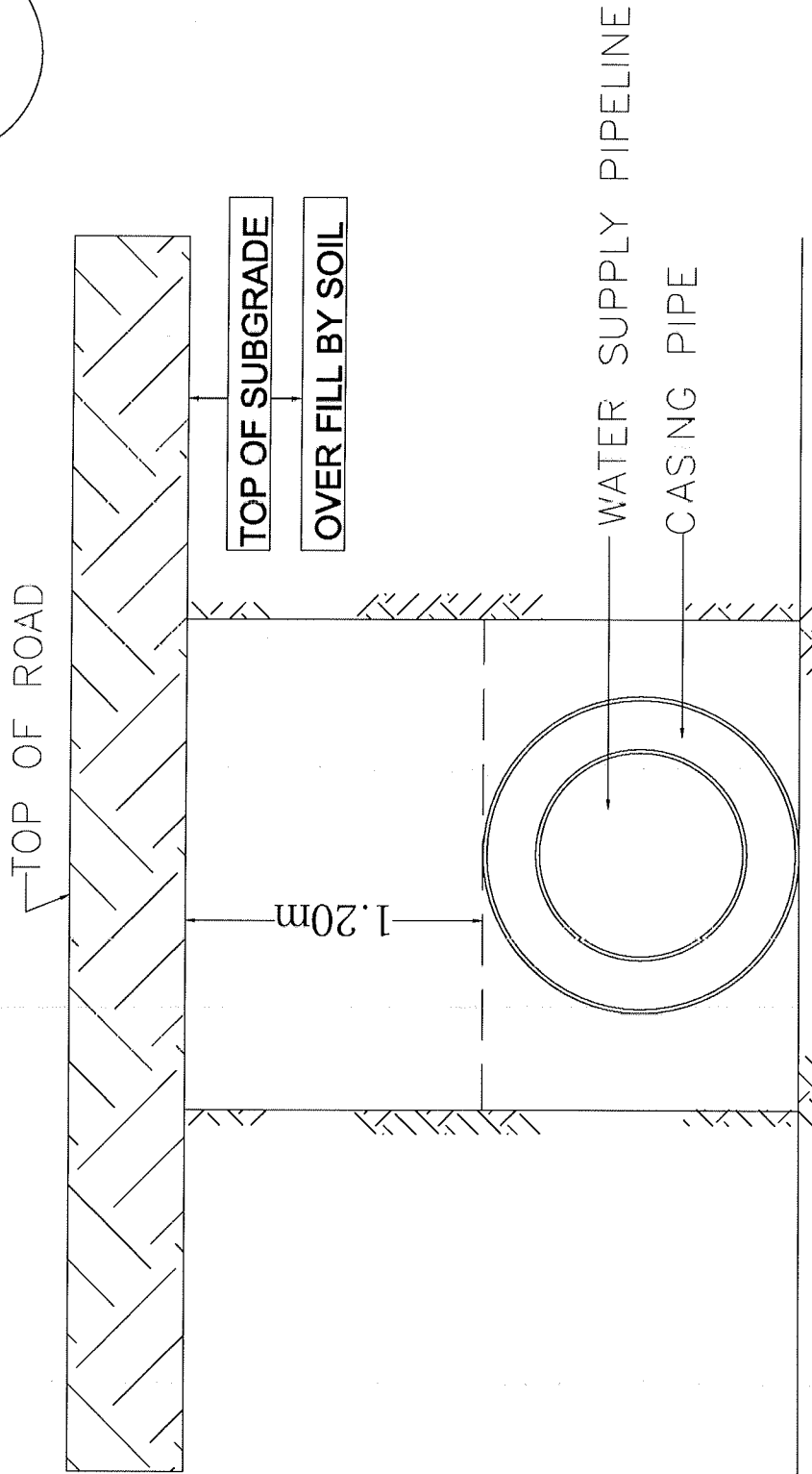

**INSTALLATION OF TRENCHLESS CASING PIPE
FOR CROSSING THE ROAD**

[Signature]

राधन त्रिपाठी / Radhavi Tripathi
प्रबंधक (सि.सं.) / Manager (Tech.)
भारतीय राष्ट्रीय राजमार्ग प्राधिकरण
National Highway Authority of India
पीओआर-३३४-वृद्धा / PIU-Roorkee

[Signature]
J.E.

पिउ

[Signature]

वि.सं. ए.ए.

प्रमुख अभियंता/प्रमुख सि.सं. अधिकारी
परियोजना निदेशक / Project Director
भारतीय राष्ट्रीय राजमार्ग प्राधिकरण
National Highway Authority of India
पीओआर-३३४-वृद्धा / PIU-Roorkee

हरिद्वार

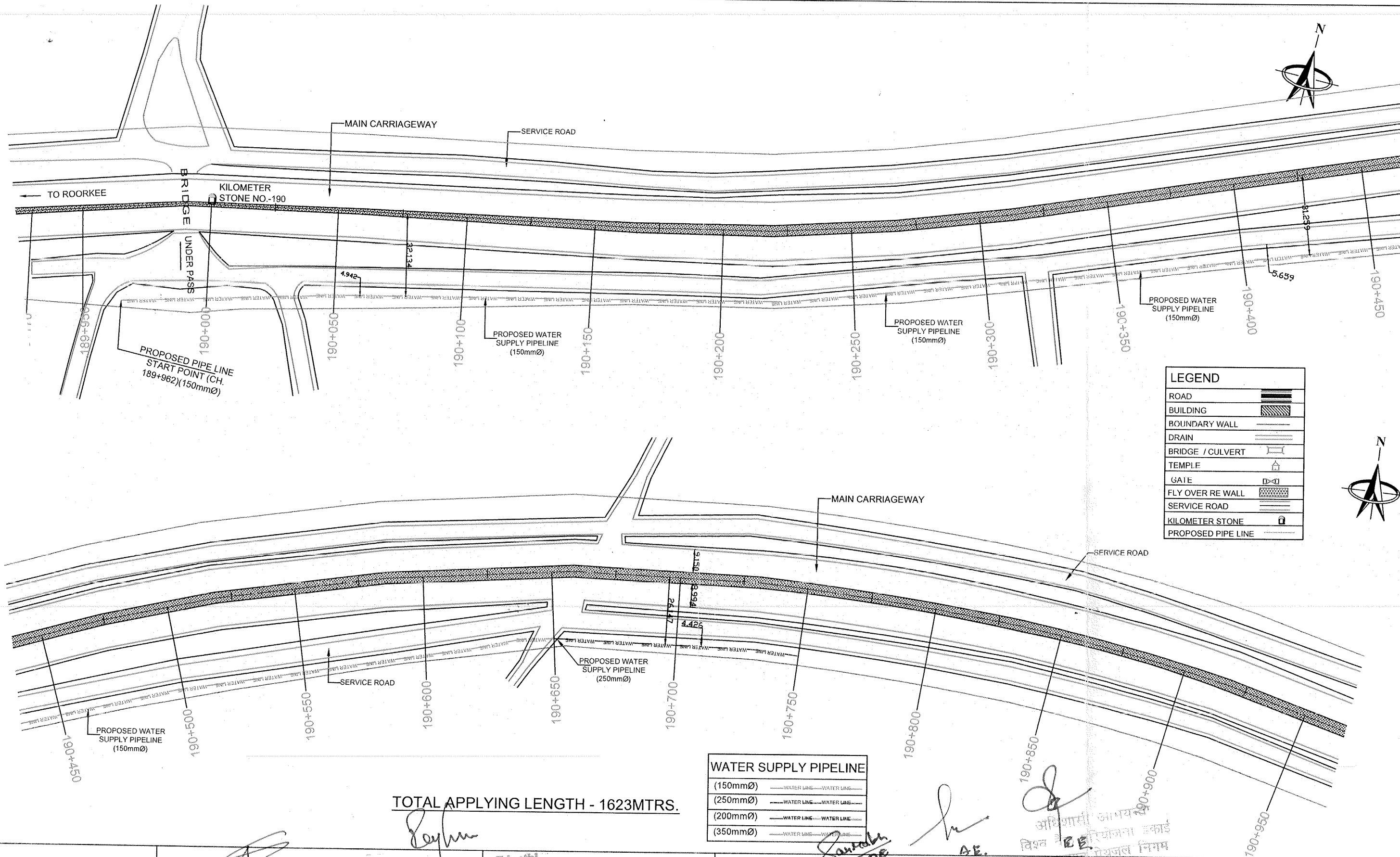

TOTAL APPLYING LENGTH - 1623MTRS.

WATER SUPPLY PIPELINE	
(150mmØ)	— WATER LINE — WATER LINE —
(250mmØ)	— WATER LINE — WATER LINE —
(200mmØ)	— WATER LINE — WATER LINE —
(350mmØ)	— WATER LINE — WATER LINE —

CLIENT:-
WORLD BANK PROJECT UNIT
UTTARAKHAND PEYJAL NIGAM,
HARIDWAR

TITLE:-
PROPOSED WATER SUPPLY PIPELINE FROM KM. (CH. 189+962
- CH.193+190)(BAHADRABAD, HARIDWAR) ALONG THE NH-58
(NEW NH-334) DISTRICT - HARIDWAR IN THE STATE OF
UTTARAKHAND.
(TOTAL APPLYING LENGTH - 1623MTRS.)

राघव त्रिपाठी / Raghav Tripathi
(CH. 189+962 - CH.190+650) 150mmØ = 688MTR.
(CH. 190+650 - CH.190+750) 250mmØ = 100MTR.
(CH. 192+350 - CH.192+600) 350mmØ = 250MTR.
(CH. 192+600 - CH.193+100) 250mmØ = 500MTR.
(CH. 193+100 - CH.193+185) 250mmØ = 85MTR.
(CH. 192+350 - CH.193+185) 200mmØ = 835MTR.
(TOTAL APPLYING LENGTH - 1623MTRS.)

NOTE :-

1. ALL DIMENSIONS, LEVELS AND CHANGES ARE IN METERS.
2. ONLY WRITTEN DIMENSION SHALL BE FOLLOWED.
DO NOT SCALE THE DRAWING.
3. WATER SUPPLY PIPELINE WILL NOT BE LAID BETWEEN KM.
CH.190.750 TO CH.192.350

PREPARED BY

TECHNICAL CONSULTANCY SERVICES
REGD. OFF. 14-C ARAWALI ENCLAVE,
GMS ROAD DEHRADUN.
TEL. NO. : 0135-2720017, 2107754
e-mail. : lcsdoon@yahoo.com
e-mail. : lcsdoon@gmail.com

1
SHEET NO

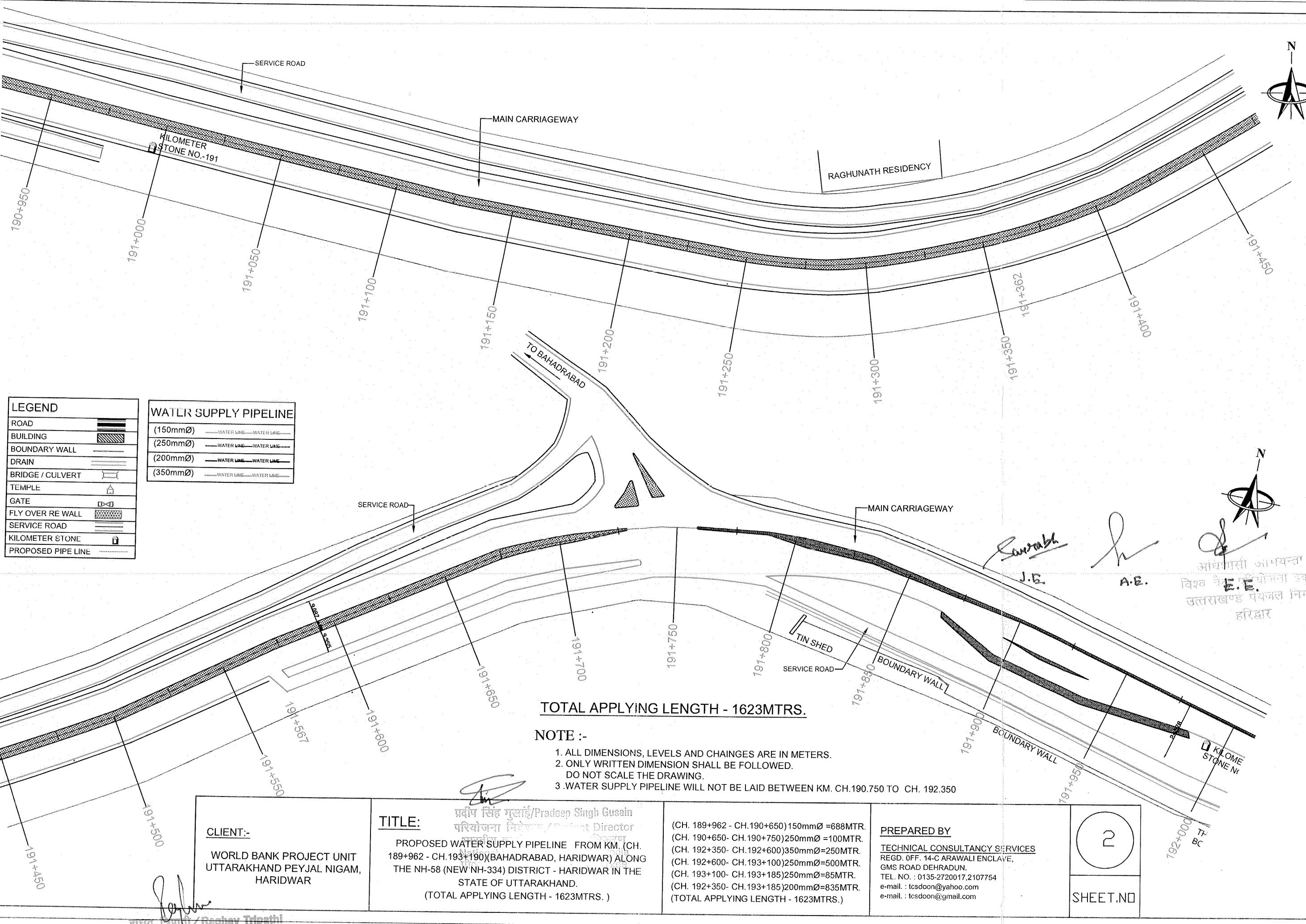

LEGEND	
ROAD	
BUILDING	
BOUNDARY WALL	
DRAIN	
BRIDGE / CULVERT	
TEMPLE	
GATE	
FLY OVER RE WALL	
SERVICE ROAD	
KILOMETER STONE	
PROPOSED PIPE LINE	

WATER SUPPLY PIPELINE	
(150mmØ)	
(250mmØ)	
(200mmØ)	
(350mmØ)	

TOTAL APPLYING LENGTH - 1623MTRS.

NOTE :-

1. ALL DIMENSIONS, LEVELS AND CHANGES ARE IN METERS.
2. ONLY WRITTEN DIMENSION SHALL BE FOLLOWED.
DO NOT SCALE THE DRAWING.
3. WATER SUPPLY PIPELINE WILL NOT BE LAID BETWEEN KM. CH.190.750 TO CH. 192.350

CLIENT:- WORLD BANK PROJECT UNIT UTTARAKHAND PEYJAL NIGAM, HARIDWAR	TITLE: प्रदीप सिंह गुसाई/Pradeep Singh Gusain परियोजना निदेशक / Project Director PROPOSED WATER SUPPLY PIPELINE FROM KM. (CH. 189+962 - CH.193+190)(BAHADRADAB, HARIDWAR) ALONG THE NH-58 (NEW NH-334) DISTRICT - HARIDWAR IN THE STATE OF UTTARAKHAND. (TOTAL APPLYING LENGTH - 1623MTRS.)	PREPARED BY TECHNICAL CONSULTANCY SERVICES REGD. OFF. 14-C ARAWALI ENCLAVE, GMS ROAD DEHRADUN, TEL. NO. : 0135-2720017,2107754 e-mail : tcsdoon@yahoo.com e-mail : tcsdoon@gmail.com	2 SHEET.NO

राधव त्रिपाठी / Raghav Tripathi
प्रबंधक (तक.) / Manager (Tech.)
भारतीय राष्ट्रीय राजमार्ग प्राधिकरण
National Highway Authority of India

आयोजना अधिकारी
विश्व बैंक परियोजना इकाई
उत्तराखण्ड पेयजल निगम
हरिद्वार
E.E.

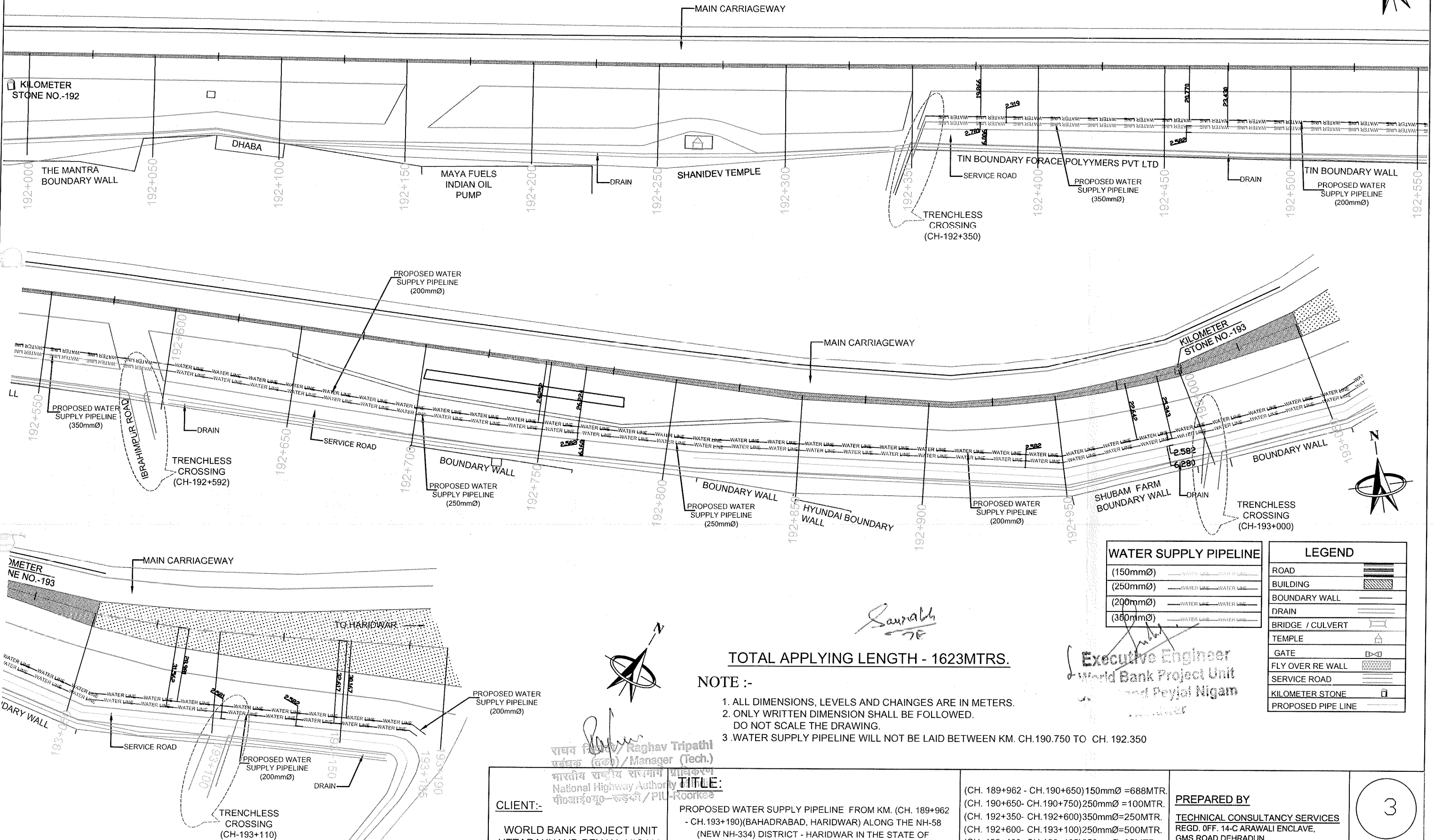
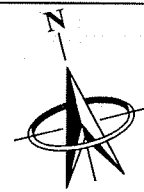

WATER SUPPLY PIPELINE	
(150mmØ)	---
(250mmØ)	---
(200mmØ)	---
(350mmØ)	---

LEGEND	
ROAD	---
BUILDING	---
BOUNDARY WALL	---
DRAIN	---
BRIDGE / CULVERT	---
TEMPLE	---
GATE	---
FLY OVER RE WALL	---
SERVICE ROAD	---
KILOMETER STONE	---
PROPOSED PIPE LINE	---

TOTAL APPLYING LENGTH - 1623MTRS.

NOTE :-

1. ALL DIMENSIONS, LEVELS AND CHANGES ARE IN METERS.
2. ONLY WRITTEN DIMENSION SHALL BE FOLLOWED. DO NOT SCALE THE DRAWING.
3. WATER SUPPLY PIPELINE WILL NOT BE LAID BETWEEN KM. CH.190.750 TO CH. 192.350

राष्ट्रीय राजमार्ग प्रबंधक (निष्पत्ति) / Manager (Tech.)
भारतीय राष्ट्रीय राजमार्ग प्राधिकरण
National Highway Authority
पी०आर०ए०पी० - रुड़की / P.O. Roorkee

CLIENT:-
WORLD BANK PROJECT UNIT
UTTARAKHAND PEYJAL NIGAM,
HARIDWAR

TITLE:-
PROPOSED WATER SUPPLY PIPELINE FROM KM. (CH. 189+962 - CH.193+190)(BAHADRAD, HARIDWAR) ALONG THE NH-58 (NEW NH-334) DISTRICT - HARIDWAR IN THE STATE OF UTTARAKHAND.
(TOTAL APPLYING LENGTH - 1623MTRS.)

(CH. 189+962 - CH.190+650)150mmØ =688MTR.
(CH. 190+650- CH.190+750)250mmØ =100MTR.
(CH. 192+350- CH.192+600)350mmØ=250MTR.
(CH. 192+600- CH.193+100)250mmØ=500MTR.
(CH. 193+100- CH.193+185)250mmØ=85MTR.
(CH. 192+350- CH.193+185)200mmØ=835MTR.
(TOTAL APPLYING LENGTH - 1623MTRS.)

PREPARED BY
TECHNICAL CONSULTANCY SERVICES
REGD. OFF. 14-C ARAWALI ENCLAVE,
GMS ROAD DEHRADUN.
TEL. NO. : 0135-2720017,2107754
e-mail. : tcsdoon@yahoo.com
e-mail. : tcsdoon@gmail.com

3

SHEET.NO